

Photodetector module type	Photomultiplier tube type
DM0036C	9111FLB
DM0047C	9113FLB

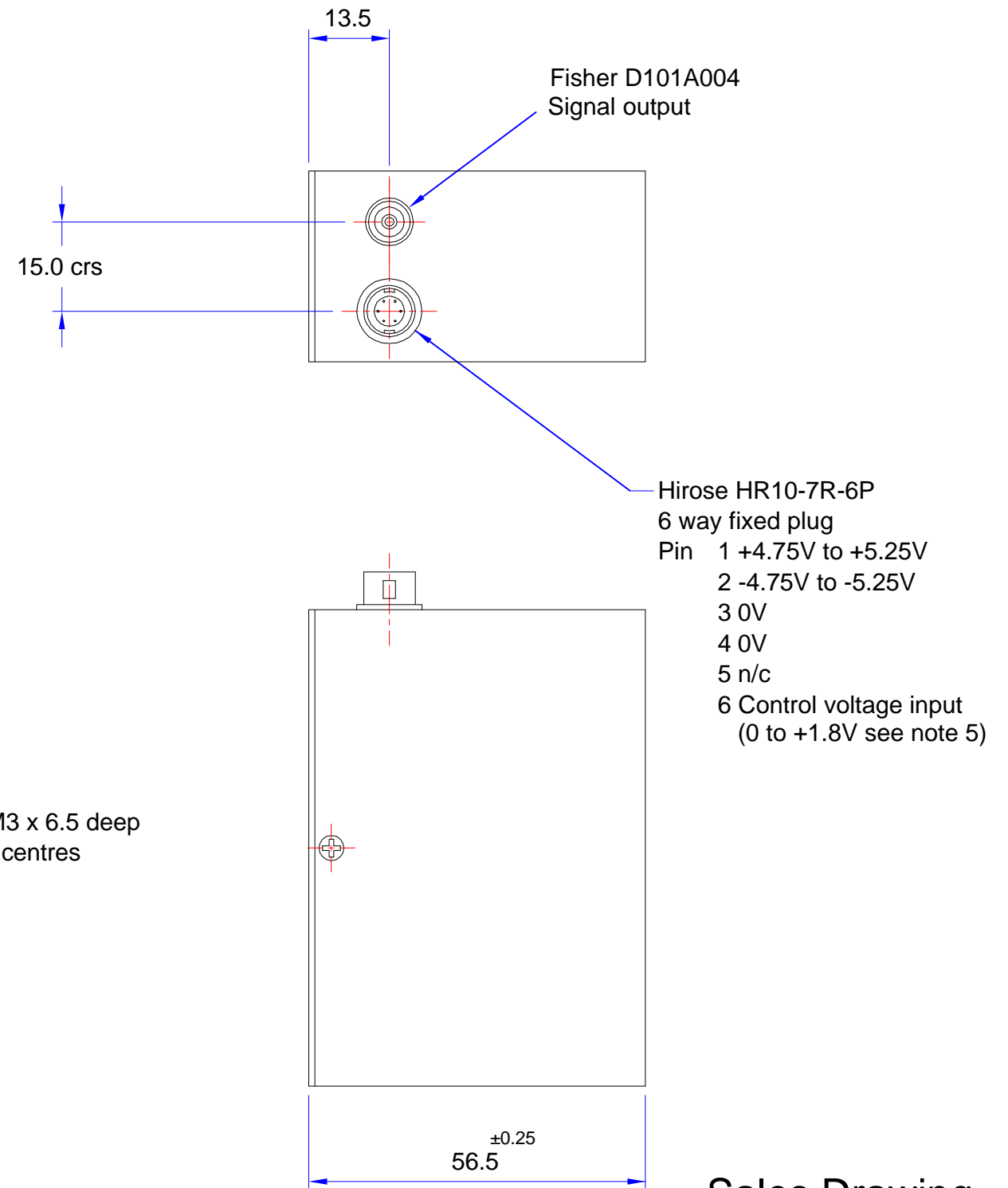

- Notes
1. Finish:
Case, black powder coat
Front plate, black anodised.
 2. Supply 0V and signal return are internally connected to the module case.
 3. Module power input typically
+5V, 80mA
-5V, 20mA
 4. 100kΩ transimpedance, 15ns t_r and t_f amplifier.
 5. Photomultiplier voltage is 1000 x voltage applied to Control Voltage Input.
DO NOT exceed maximum voltage rating of photomultiplier tube supplied.

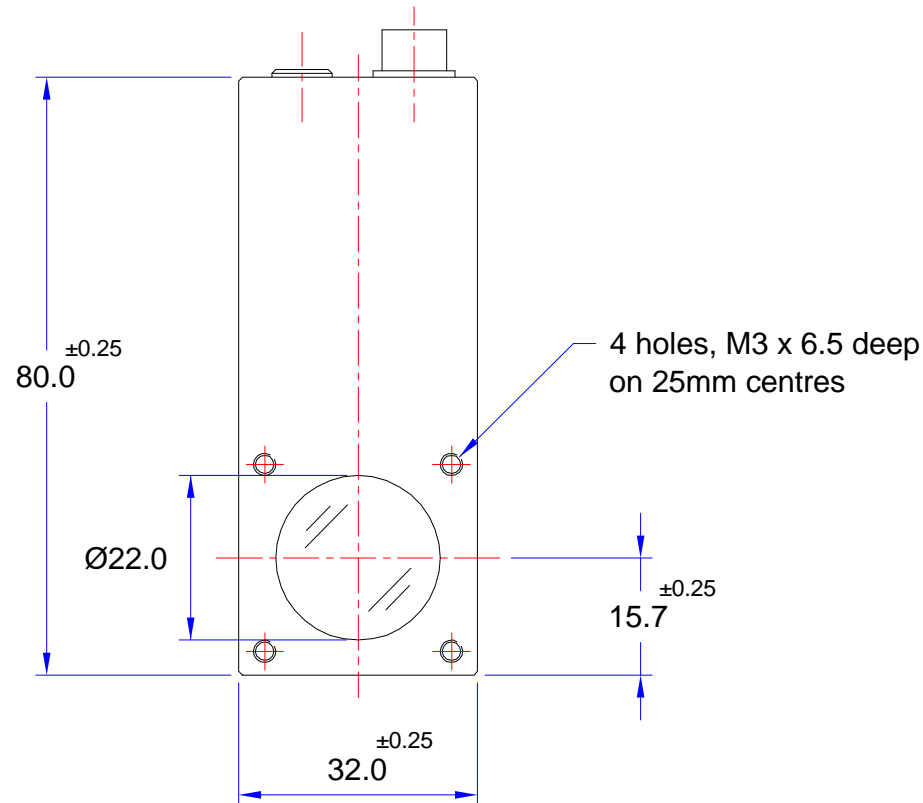

Sales Drawing

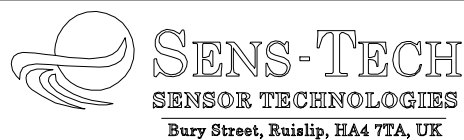

Issue	Date	C/Note No.	Sign	Material
1	11.03.03			
2	26.01.04			Finish
3	26.05.09	S00206	AS	
4	07.01.10	S00259	AS	Surface finish

Unless otherwise specified	N7
----------------------------	----

Drawn by	M. Stoodley
Date	11 March 2003
Scale	1:1
Checked	M. Stoodley
Approved	R. Ellis
Sheet size	A3 F/DO007 issue 1

Project	DM0036C DM0047C
Title	Photodetector module
Drawing Number	25894 C 1128
Sheet	1 of 1

Confidentiality Notice . This document (including all information contained therein) is owned by Sens-Tech Limited and must be kept in confidence and used solely for the owner's specified purposes. This document must not be copied or reproduced, nor divulged, in whole or part, without the owner's prior written consent.

THIRD ANGLE PROJECTION